



# Mark 7 0-10V

## MARK 7 0-10V ELE DIM BAL (2) 26W CFL (4-PIN) 120-277V

The Mark 7 0-10V series of dimmable electronic ballasts offer maximum versatility by incorporating separate control leads for use with a wide array of controllers, including occupancy sensors, daylight harvesting controls, and building management systems from more than 40 manufacturers. When paired with linear fluorescent and 4-pin compact fluorescent lamps, these ballasts optimize the benefits of such popular sustainable lighting techniques as daylight harvesting, occupancy sensing, and load shedding to satisfy the need for an affordable, flexible and versatile controllable lighting solution.

### Product data

General Information	
Lamp Type	CFQ26W/G24Q
Number of Lamps	1/2 piece/unit
Ballast Type	Dimmable Fluorescent
Base Model	IZT2S26M5BS
Suitable For Outdoor Use	Yes
Automatic Restart	Yes
Operating and Electrical	
Input Voltage	120 to 277 V
Input Frequency	50 to 60 Hz
Total Harmonic Distortion USA	10 %
Ignition Method	Programmed Start
Crestfactor (Nom)	1.6
Ignition Time (Nom)	1.5 s
Ballast Factor (Max)	1
Ballast Factor (Min)	0.03
Power Factor (Nom)	0.99

Input Current (Max)	0.46 A
Input Current (Min)	0.20 A
Input Power (Max)	55 W
Input Power (Min)	13 W
Rated Lamp Power	26 W
Wiring	
Color Input Terminals	Black, White, Violet and Gray
Color Output Terminals	RED, YEL & BLU
Wire Striplength	0.375 mm
Control Wire Gauge	18AWG
Lamp Connection	Series
Wire Length by Color	No wires
Wire Gauge (Nom)	18AWG mm
Wire Type	Solid
Remote Wiring Configuration Allowed	No
Tandem Wiring Configuration Allowed	No
Through Wiring Configuration Allowed	No

## Mark 7 0-10V

Max Ballast-Lamp Distance Remote Wiring	No Remote
Max Ballast-Lamp Distance Tandem Wiring	No Tandem
Max Ballast-Lamp Distance Through Wiring	No Through
Connector Type	Poke-In

### Temperature

T-Case Maximum (Nom)	70 °C
----------------------	-------

### Mechanical and Housing

Housing Material	Metal
Housing	M5
Housing Dimensions	4.98" x 3.0" x 1.18"

### Approval and Application

EMC Immunity Standard	FCC Consumer
Approval Marks	CSA certificate UL certificate CEC Listing RoHS Compliant

Hum And Noise Level	A
UL Recognized	No

### Product Data

Order product name	MARK 7 0-10V ELE DIM BAL (2) 26W CFL (4-PIN) 120-277V
EAN/UPC - Product	781087032817
Order code	913710213602
Numerator - Quantity Per Pack	1
Numerator - Packs per outer box	16
Material Nr. (12NC)	913710213602
Net Weight (Piece)	0.350 kg

## Dimensional drawing

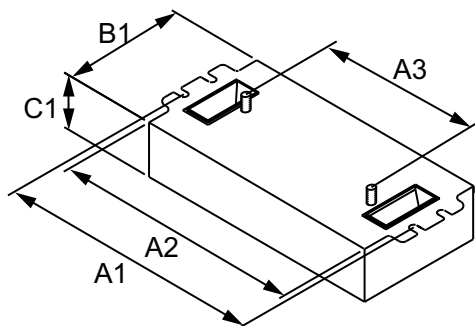

ELE DIM BAL (2) 26W CFL (4-PIN) 120-277V

Product	A1	A2	A3	B1	C1
MARK 7 0-10V ELE DIM BAL (2) 26W CFL (4-PIN) 120-277V	4.55 in	4.20 in	2.00 in	3.00 in	1.29 in

